

RC (Reverse Circulation)

Diameter: **OD = 76-305 mm**
 Length: **S/S = 500-10000 mm**

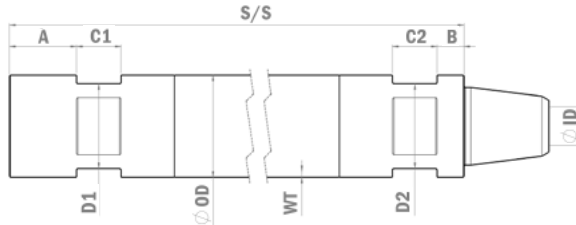

Outer diameter (mm)	Wall thickness (mm)	S/S length (mm)	Thread	Flats (mm)	Weight (kg)	Part Number
COMMON DIAMETERS						
76	4-8	500-10000	See below			On Request
83	4-8	500-10000	See below			On Request
89	4-8	500-10000	See below			On Request
102	4-8	500-10000	See below			On Request
114	5-12	500-10000	See below			On Request
127	6-12	500-10000	See below			On Request
140	8-19	500-10000	See below			On Request
152	10-25	500-10000	See below			On Request
159	10-25	500-10000	See below			On Request
165	10-25	500-10000	See below			On Request
168	10-25	500-10000	See below			On Request
178	10-25	500-10000	See below			On Request
194	12-25	500-10000	See below			On Request
219	12-25	500-10000	See below			On Request
235	12-25	500-10000	See below			On Request
273	12-25	500-10000	See below			On Request
305	12-25	500-10000	See below			On Request

Driconeq manufactures all types of RC-pipes. Common threads on Driconeq RC-pipes is: DR, METZKE, REMET, MATRIX, FABER and CSR.